

BTICINO > Low voltage energy distribution > MEGATIKER - moulded cas circuit breakers > Accessories for draw-out/plug-in version

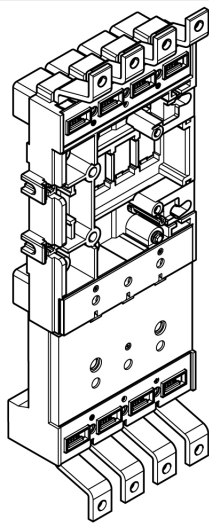



M7B17

Base 4P+ELM with rear terminals for circuit breakers M4 630 plug-in/draw-out version (with earth leakage module)

Technical features

Standard reference	CEI EN 60947-2
N° of poles	4P+D
Series	Megatiker

Documentation

-  [Instructions Sheet](#)
-  [Catalogue Megatiker](#)

Related products

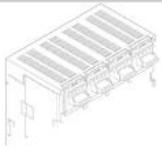

M7B12

Kit of connection terminals for circuit breakers M4 630 4P plug-in/draw-out version (packaging 8 pieces)

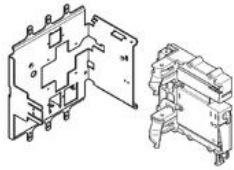

M7B22

Transformation kit to apply at the plug-in bases 3P for circuit breakers M4 630



MT7412

Operation crank for the extraction of MCCBs

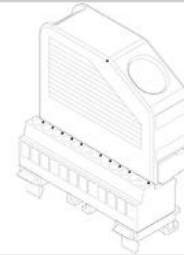

M7B20

Kit of connectors 24-pin for electrical auxiliaries

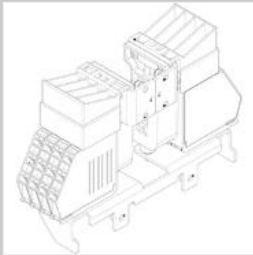

M7B21

Auxiliary contact for circuit breaker M4 630 and M5 1600 in draw-out version (packaging 2 pieces)

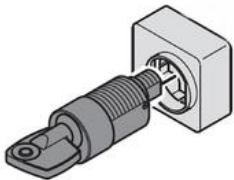

M7B33

Key-lock type Profalux for plug-in or draw-out bases for circuit breaker M4 630 and M5 1600

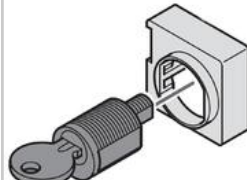

M7B34

Key-lock type Ronis for plug-in or draw-out bases for circuit breaker M4 630 and M5 1600



M7B19

Couple of extractors for circuit breakers M4 630 in plug-in version