

BTICINO > Low voltage energy distribution > Circuit breakers for protection > MEGATIKER - moulded case circuit breakers > Accessories for draw-out/plug-in version

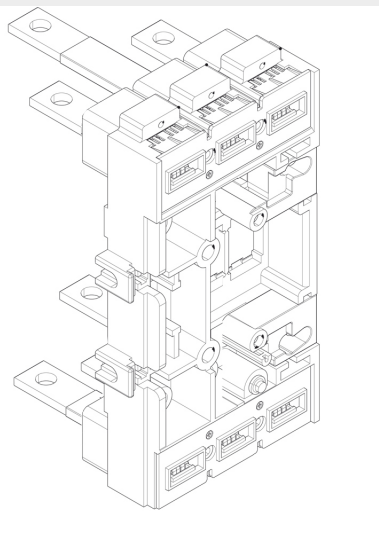

M7B15

Base 3P with rear terminals for circuit breakers M4 630 plug-in/draw-out version

Technical features

Brand	BTicino
Standard reference	CEI EN 60947-2
N° of poles	3P
Series	Megatiker

Documentation

 [Instruction Sheet](#)

Related products

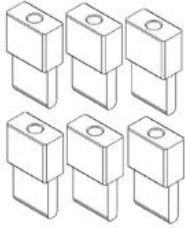

M7B11

Kit of connection terminals for circuit breakers M4 630 3P plug-in/draw-out version (packaging 6 pie...

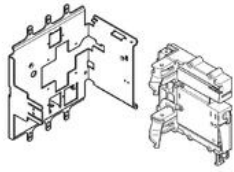

M7B22

Transformation kit to apply at the plug-in bases 3P for circuit breakers M4 630



MT7412

Operation crank for the extraction of Mccb's

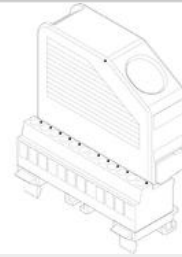

M7B20

Kit of connectors 24-pin for electrical auxiliaries

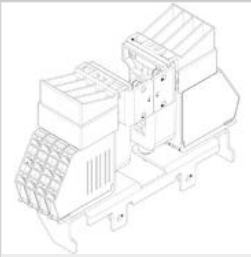

M7B21

Auxiliary contact for circuit breaker M4 630 and M5 1600 in draw-out version (packaging 2 pieces)

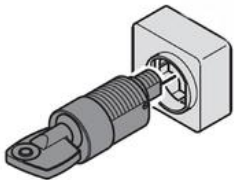

M7B33

Key-lock type Profalux for plug-in or draw-out bases for circuit breaker M4 630 and M5 1600

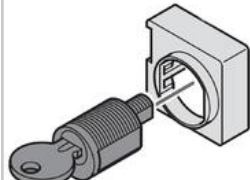

M7B34

Key-lock type Ronis for plug-in or draw-out bases for circuit breaker M4 630 and M5 1600



M7B19

Couple of extractor for circuit breakers M4 630 in plug-in version