

BTICINO > Low voltage energy distribution > MAS160 - Distribution boards > Wall mounted distribution boards

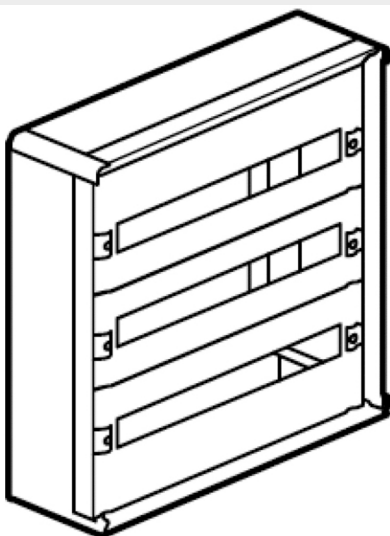



94530L

SDX-L - wall-mounting distribution board 515x550x145mm
complete with panels 72 modules DIN35

Technical features

Protection index	IP43
Height	550mm
Width	515mm
Depth	145mm
N° of modules	72
Standard reference	CEI EN 61439-1/2
Series	Mas 160

Documentation

-  [Instructions Sheet](#)
-  [_DWG drawing_](#)
-  [Mas160 catalogue](#)

Related products



9429/24Q

Metallic front panel 1/4 turn with DIN35 window for installation up to 24 modules 515x150mm

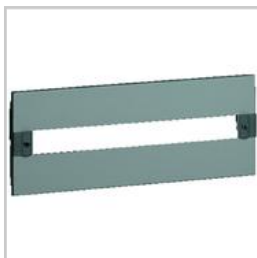

9431/24Q

Metallic front panel 1/4 turn with DIN35 window for installation up to 24 modules 515x200mm

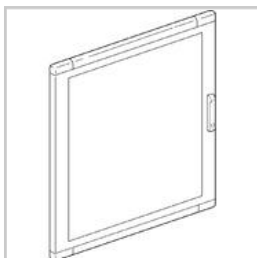

94530VE

Glass door for SDX distribution boards 515x550mm

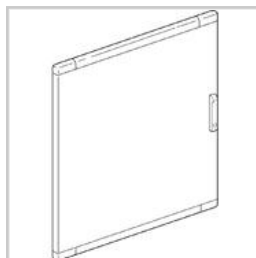

94530LA

Blank door for SDX distribution boards 515x550mm

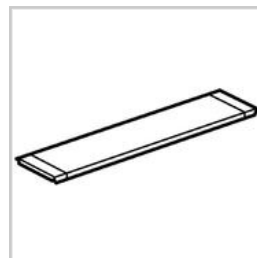

94500PP

Cable entry plate for SDX-L

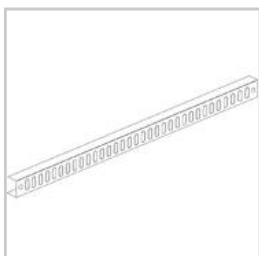

94500TRO

SDX-L horizontal cable fixing bar